

NOTICE - PROPRIETARY INFORMATION
 THE DESIGN AND RELATED INFORMATION CONTAINED HEREIN
 IS THE SOLE PROPERTY OF COFAN USA INC. THE DISCLOSURE
 OF THIS INFORMATION DOES NOT CONSTITUTE THE RELEASE OF
 ANY PROPRIETARY RIGHTS THEREIN. PERMISSION TO REPRODUCE
 THIS INFORMATION OR THE PRODUCTS DISCLOSED HEREIN
 MUST BE OBTAINED IN WRITING FROM COFAN USA INC.

REVISION HISTORY					
REV	DESCRIPTION	DRWN	CHK'D	APP'VD	DATE

NOTES

- 1. MATERIAL: AL 6063-T5
- 2. FINISH: BLACK ANODIZE
- 3. PART WEIGHT: 21.17g
- 4. Δ IS CRITICAL INSPECTION POINT. NUMBERING IN TRIANGLE IS TO BE USED FOR CROSS REFERENCE OF INSPECTION REPORT TO DRAWING DIMENSION OR FEATURE.
- 5. NO SHARP BURR OR EDGES

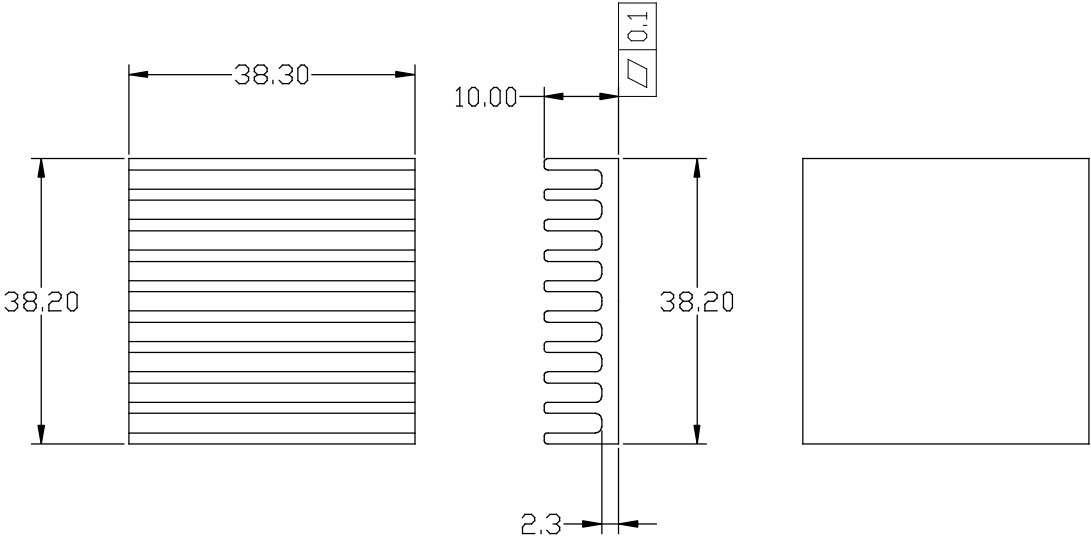
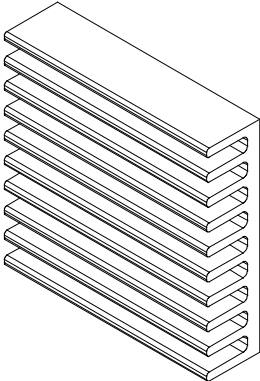

**RoHS
 Compliant
 2002/95/EC**

DO NOT SCALE DRAWING		NAME:	DATE:	CUSTOMER DRAWING NUMBER:	 46177 WARM SPRINGS BLVD FRENCH CREEK CA 94539	
UNLESS OTHERWISE SPECIFIED DIMENSIONS ARE IN MILLIMETRE TOLERANCES ARE:		DRAWN BY:	IVNLC	6/8/12	CUSTOMER PART NUMBER:	NAME:
1 PLACE .X	± 0.2	CHECKED BY:			HEAT SINK, 38.2X38.3X10MM	
2 PLACE .XX	± 0.12	CHECKED BY:			COFAN DRAWING NUMBER:	SCALE:
3 PLACE .XXX	± 0.06	APPR BY:			20-1088	1:1
ANGLES EXCEPT 90°	± 0.5°				COFAN PART NUMBER:	CUS REV:
MAXIMUM SURFACE ROUGHNESS	3.2 $\sqrt{\text{ }}$				20-1088	-
					SHEET:	COF REV:
					1 OF 1	01
						DATE DRAWN:
						JUN-8-2012