

LH-50E50C

PAR16 / GU10

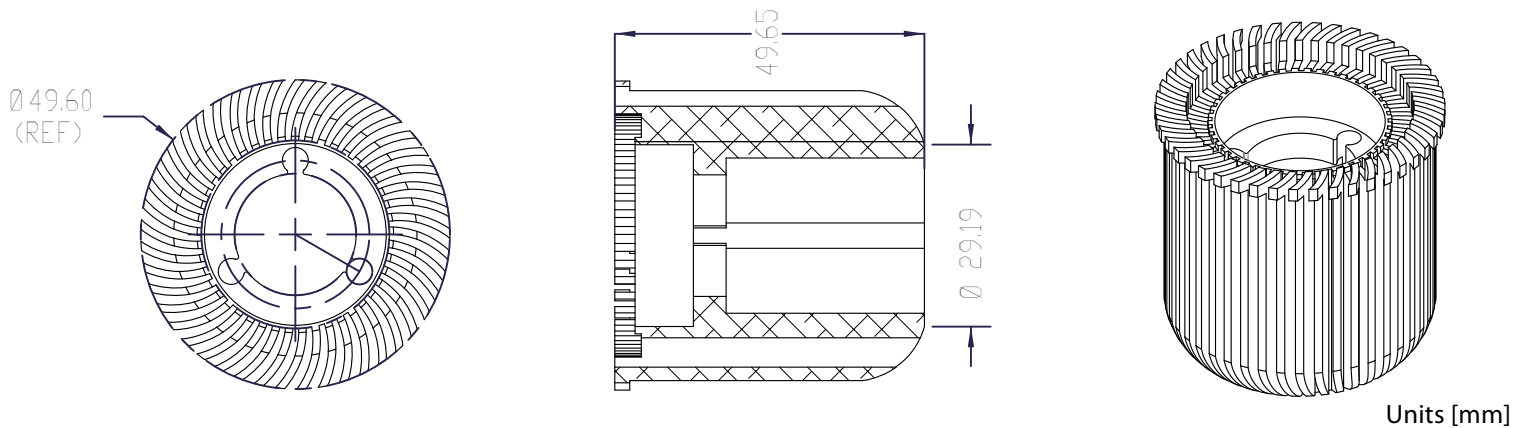

DIMENSIONS DRAWING



Units [mm]

Part Number	Dimensions		Material(s)	Surface Finish	Weight [Gram]	Maximum Power [Watt]	Bulb Shape	Manufacturing Processes
	Diameter [mm]	Height [mm]						
LH-50E50C	49.60	49.65	AL6063-T5	Clear Anodized	81.5	3	PAR16 / GU10	Extrusion Machining

** Specifications are subject to change without notice.